

1 TOP VIEW

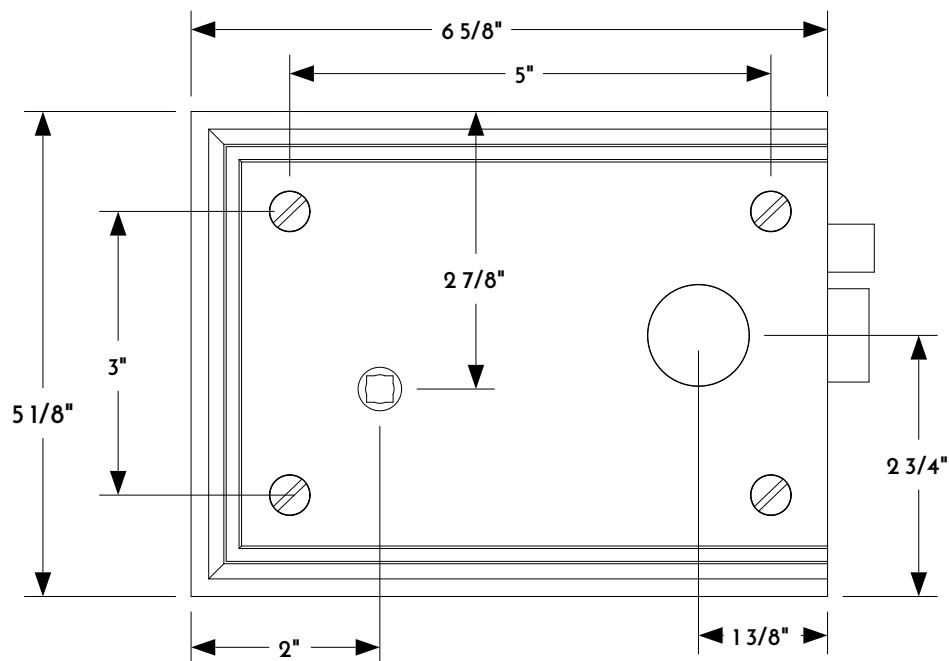

2 FRONT VIEW

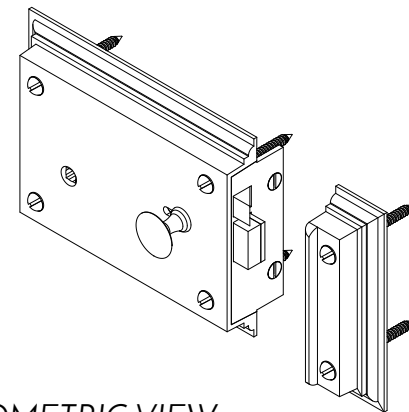

3 ISOMETRIC VIEW

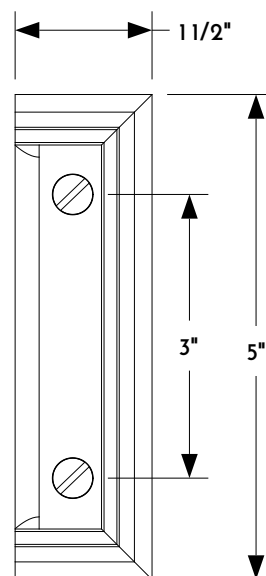

NOTE: Items are hand made one at a time.
There may be slight variations in measurement
and tolerances when comparing to actual Cad
drawing.

CONFIDENTIALITY STATEMENT. The information contained in
this Drawing, including attachments, is confidential information property
of Heritage Metalworks LLC., HMW Forge and Scofield lighting. The
information is intended for use solely by the individual or entity named
in the message and or email sent with. Any unauthorized review,
printing, copying, reproduction or distribution of such information to
other parties is prohibited. If you are not an intended recipient of this,
please notify Heritage Metalworks LLC. by reply e-mail and delete from
your system.

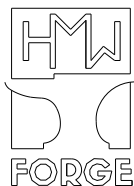

Heritage Metalworks LLC.

HWBS108-LO2

6 x 4 Molded Brass Lock, Sliding Deadbolt

Revision : 1
Rev Date : 11/2/21
Notes : New Format
Drawn By : CLL